

NOTES:
 1. RECOMMENDED SCREW SIZE INTO DOOR #6X 1/2" (PROVIDED BY RAS)
 QTY 6

CUSTOMER DRAWING

This drawing is the property of Rev-A-Shelf (RAS) and is disclosed in confidence to the extent its subject matter is original to RAS. Any vendor receiving this drawing from RAS shall hold and use this drawing for the sole benefit of RAS and shall not disclose it to, or use or reproduce it for any third party, or perform any act adverse to the interest of RAS with respect to this drawing without the express written permission of RAS. Vendors shall not revise any physical, dimensional or performance characteristic unless authorized by Rev-A-Shelf Engineering.

REV.	DATE	BY	DESCRIPTION OF CHANGE
A	10-5-10	KRR	ECN10-113

INCH [MM]	AMERICAN PROJECTION	BY	DATE	REV-A-SHELF, INC.
		DRAWN	KRR 6-18-10	
		MATERIAL	DRAWING NO.	SCALE
		FINISH	448P5111-CUSTOMER	0.125
			PART NO.	SHEET OF
			448P5111	1 2

TOLERANCES
 MAT. DEC.
 (WOOD) .XX ±.03 [.8mm]
 (OTHER) .XX ±.02 [.5mm]
 (ALL) .XXX ±.005 [.13 mm]
 FRACTIONS ±1/32 [.8 mm]

ANGLES
 ±1/2°

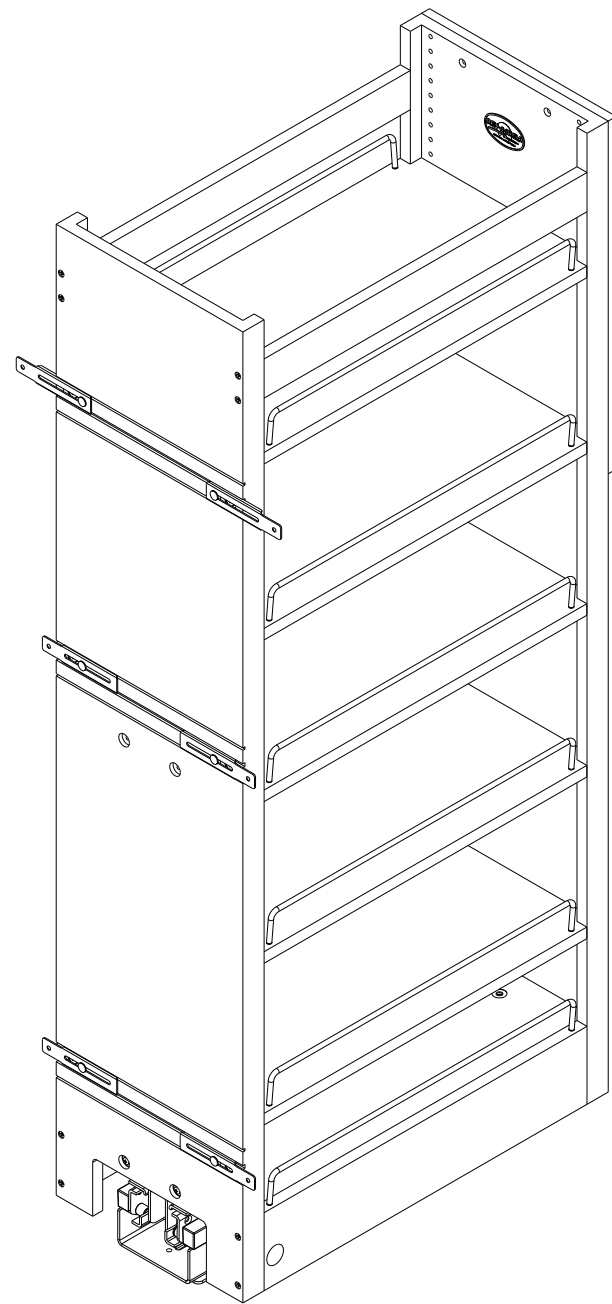

PART DIMENSIONS		
	MIN	MAX
WIDTH	11.00 [279,4]	
DEPTH	22.00 [558,8]	
HEIGHT	50.72 [1288,2]	59.32 [1506,7]

MIN CABINET OPENING				
	FACE FRAME	FRAMELESS	INSET FACE FRAME	INSET FRAMELESS
WIDTH	11.50 [292,1]	11.50 [292,1]	11.50 [292,1]	11.50 [292,1]
DEPTH	22.00 [558,8]	22.00 [558,8]	22.75 [577,9]	22.75 [577,9]
HEIGHT	51.00 [1295,4]	51.00 [1295,4]	51.00 [1295,4]	51.00 [1295,4]

PRODUCT MAX WEIGHT RATING
BHMA STANDARD

SLIDE SPECIFICATIONS				
SLIDE TYPE	HEAVY DUTY	SLIDE EXTENSION	527MM	MAX WEIGHT RATING 450 LB
SLIDE CLOSING	SOFT CLOSE	SLIDE LENGTH	546MM	
SLIDE MOUNTING	FLOOR	SLIDE FINISH	WHITE	

CUSTOMER DRAWING

This drawing is the property of Rev-A-Shelf (RAS) and is disclosed in confidence to the extent its subject matter is original to RAS. Any vendor receiving this drawing from RAS shall hold and use this drawing for the sole benefit of RAS and shall not disclose it to, or use or reproduce it for any third party, or perform any act adverse to the interest of RAS with respect to this drawing without the express written permission of RAS. Vendors shall not revise any physical, dimensional or performance characteristic unless authorized by Rev-A-Shelf Engineering.

REV.	DATE	BY	DESCRIPTION OF CHANGE
A	10-5-10	KRR	ECN10-113

	AMERICAN PROJECTION	BY	KRR	DATE	6-18-10		
	INCH [MM]	DRAWN					
TOLERANCES MAT. DEC. (WOOD) .XX ±.03 [.8mm] (OTHER) .XX ±.02 [.5mm] (ALL) .XXX ±.005 [.13 mm] FRACTIONS ±1/32 [.8 mm]		ANGLES	±1/2°	MATERIAL		DRAWING NO. 448P5111-CUSTOMER	SCALE 0.125
		FINISH		PART NO.	448P5111	SHEET OF 2 OF 2	